



27 Wooroo Street, Albion Park Rail

**SOLD**

Property ID: 6422156



**Auction unless sold prior**

Location and lifestyle is what this property is all about. Located on a 788 m2 flat block, with an R3 zoning. Just metres away from the lake foreshore/bike and walking trails and beaches, only a mere 7-minute walk to the local shops, cafes, and local train station.

This property carries great development potential for the savvy investor or family who are looking to capitalise on their investment in the future (STCA).

If you are in the market for a great holiday getaway less than an hour from Sydney, then this property is the one for you.

The large block has plenty of room for your boats, vehicles and growing family. The South Coast is a booming hotspot with great property growth. Currently rented out to excellent tenants at \$550wk, making this a stellar investment opportunity.

Disclaimer: All information contained herein is obtained from property owners or third-party sources which we believe are reliable. We have no reason to doubt its accuracy, however we cannot guarantee it. All interested person/s should rely on their own enquiries

**Features**

- Car Parking - Surface
- Carpeted
- Close to Schools
- Close to Shops
- Close to Transport
- Pet Friendly

Land Area: 788 sqm



**Monique Field**  
Principal - Monique Field Property

M: 0403 021 172  
E: monique.field@smileelite.com

**MONIQUE FIELD**  
PROPERTY

**27 WOOROO STREET, ALBION PARK RAIL**  
Total 234.4 m<sup>2</sup>

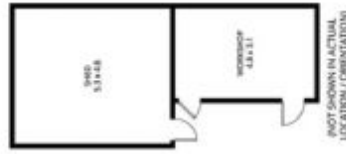

Scale in metres. Dimensions are approximate. All information contained herein is gathered from sources we believe to be reliable, however we cannot guarantee its accuracy and interested persons should rely on their own enquiries.

POWERED BY SMILE ELITE™  
PROUD PARTNERS WITH SYDNEY COUNTRY LIVING