



52 Kruseana Avenue, Goonellabah
SOLD

Property ID: 6493255



Land Area: 1337 sqm



Lyn Youngberry
 Principal - Lyn Youngberry Property

M: 0411 507 209

E: lyn.youngberry@smileelite.com

Room for a Shed or a Granny Flat or Both

Situated in arguably the best location in Kruseana Avenue, Goonellabah, this property not only has views that are out of this world but also is set on a beautiful big 1,337sqm allotment which has enough room for a shed, granny flat or both. The property will suit first time home buyers, families, investors retirees and has so much to offer including:

- 4 bedrooms, 2 living areas, huge level yard at rear
- 40 minutes to Byron Bay, 30 minutes to Ballina Airport, 60 minutes to Gold Coast Airport
- North facing covered patio with separate pergola at rear of home
- Brick and Colorbond low maintenance home
- Lock up garage with loads of storage

For more information or to arrange an inspection, contact Lyn Youngberry on 0411 507 209.

Disclaimer: All information contained herein is obtained from property owners or third-party sources which we believe are reliable. We have no reason to doubt its accuracy, however we cannot guarantee it. All interested person/s should rely on their own enquiries.

Features

- | | |
|-----------------------|--------------------|
| Area Views | Close to Shops |
| Built-ins | Close to Transport |
| Car Parking - Surface | |
| Close to Schools | |

LYN YOUNGBERRY
PROPERTY

52 KRUSEANA AVENUE, AVENUE

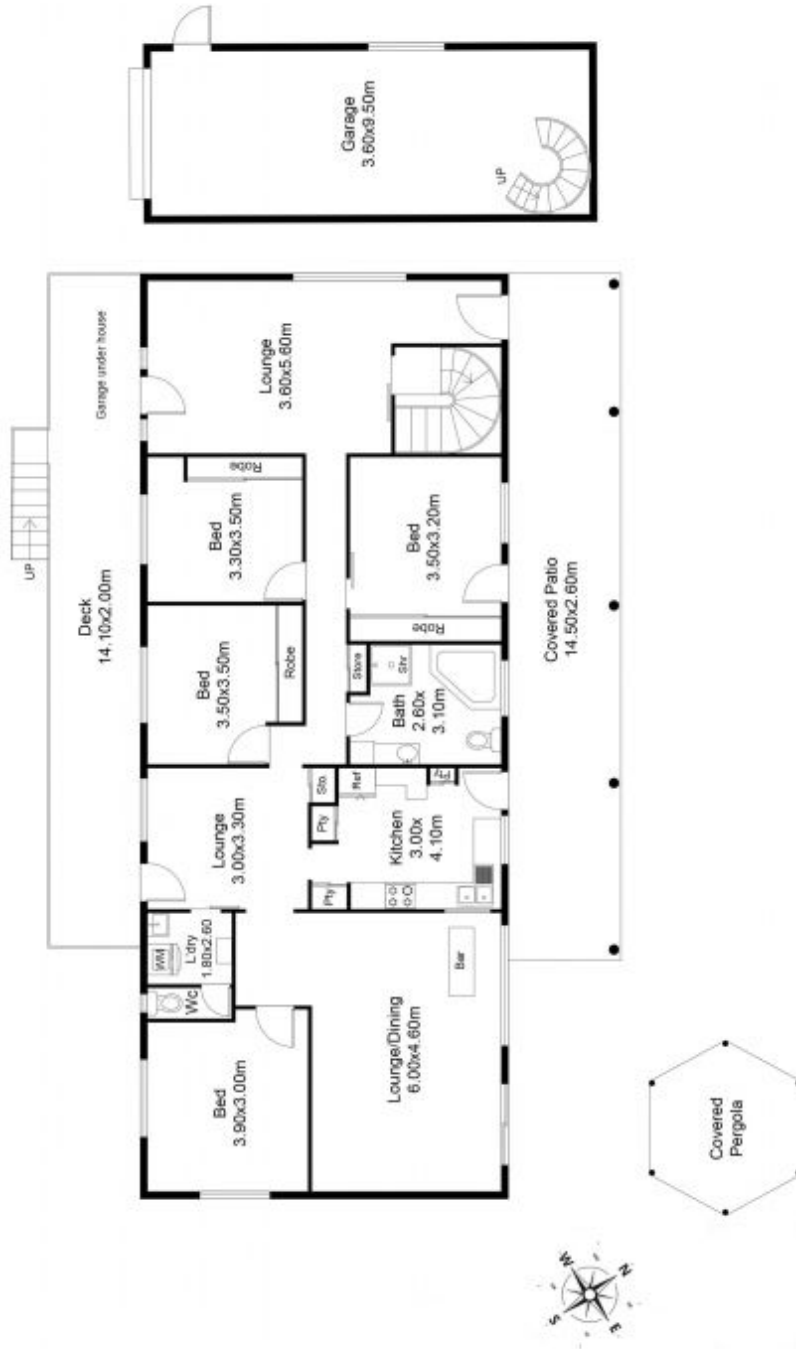

POWERED BY SMILE ELITE™
PROUD PARTNERS WITH SYDNEY COUNTRY LIVING

Scale in metres. Dimensions are approximate. All information contained herein is gathered from sources we believe to be reliable, however we cannot guarantee its accuracy and interested persons should rely on their own enquiries.